



MOVE INN ESTATES

MAKING THE RIGHT MOVE



Ashmount Crescent

, Slough, SL1 5AW

Offers In Excess Of £500,000



Floor Plan

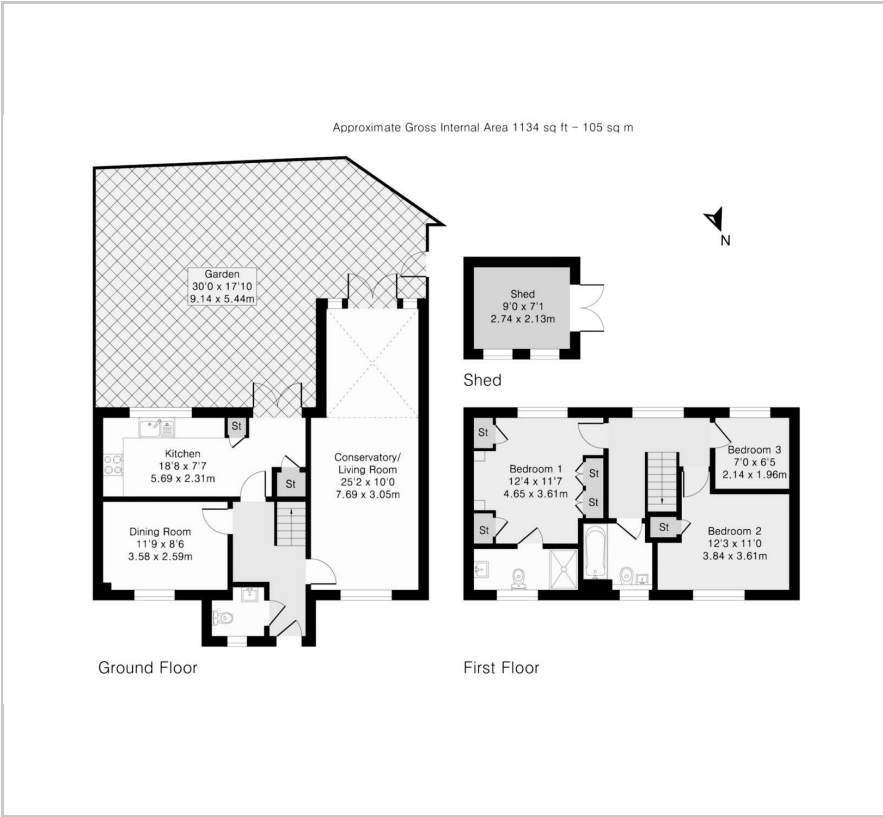

Area Map



Energy Efficiency Graph

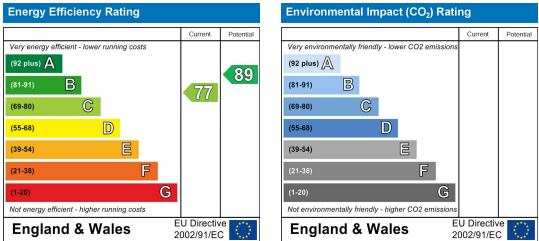

Viewing

Please contact our Move Inn Iver Office on 01753900950 if you wish to arrange a viewing appointment for this property or require further information.

- 3/4 bedrooms
- Off street parking
- Excellent location
- Approved planning permission for an extension
- Three bathrooms
- Modernised throughout
- Semi-detached



Situated in the sought-after residential area of Ashmount Crescent, Slough, this well-proportioned three-bedroom home offers a blend of spacious living and practical design, making it an excellent choice for families or professionals.

The ground floor features a welcoming hallway leading to a bright dining room and a well-sized kitchen with access to the garden. A generously sized conservatory/living room at the rear provides a fantastic space for relaxation or entertaining, with direct access to the private garden. Additionally, a convenient downstairs WC adds to the functionality of the home.

Upstairs, the property offers three bedrooms, including a spacious main bedroom with built-in storage. The second bedroom is well-sized, while the third bedroom provides flexibility for use as a child's room, guest space, or home office. A family bathroom completes the upper level.

Externally, the property boasts a private garden, ideal for outdoor dining or family activities, along with a separate shed for storage. Off-street parking is an added advantage as well as approved planning for an extension.

Located in a quiet and well-connected area, Ashmount Crescent offers easy access to local amenities, schools, and transport links, making it a great place to call home.



These particulars, whilst believed to be accurate are set out as a general outline only for guidance and do not constitute any part of an offer or contract. Intending purchasers should not rely on them as statements of representation of fact, but must satisfy themselves by inspection or otherwise as to their accuracy. No person in this firm's employment has the authority to make or give any representation or warranty in respect of the property.